

FILED
GREENVILLE CO. S.C.

SEP 16 4 42 PM '80

DONNIE S. TANKERSLEY
R.M.C.

MICROFILMED

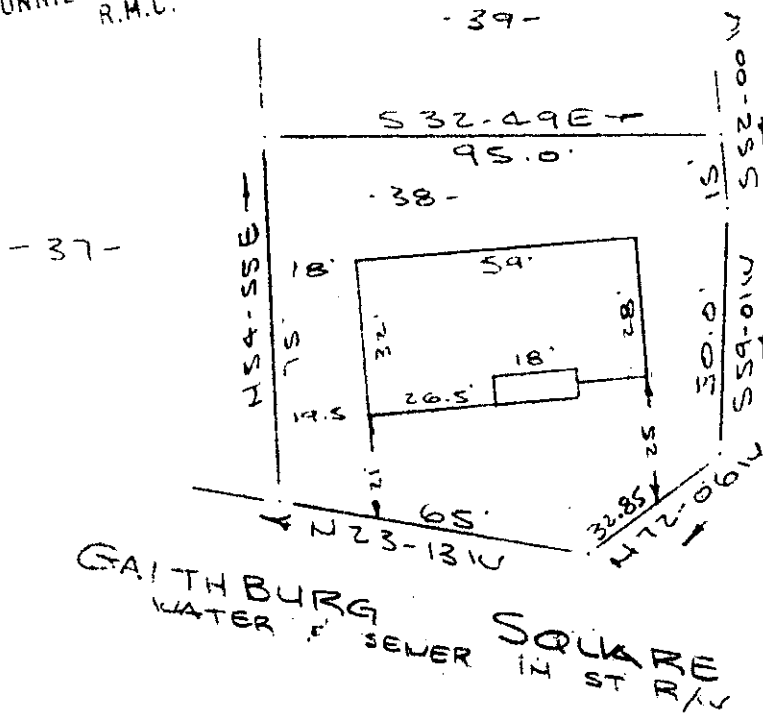

BLACKENRIDGE DRIVE
WATER & SEWER IN ST R/W

Note:
Improvements on this
lot are not in a
flood hazard area.

PROPERTY OF
COBB BUILDERS, INC.
NEAR GREENVILLE, S.C.
SCALE: 1" = 40'
15 SEPT 1980

This is to certify that on the 15th day of September, 1980, I surveyed the property shown on this plat, being known as lot 58 on plat of EASTGATE VILLAGE and recorded in the RMC Office Greenville County, S. C., in Plat Book " 4 - X " at Page 31; and that the property lines, walls and buildings are as shown hereon, and that the walls and buildings located on said lot do not encroach or project on adjacent street or property, and that no adjacent walls or buildings encroach or project on adjacent street or property, and that no adjacent walls or buildings encroach or project on said premises, and no power lines cross this property except as shown hereon.

R. B. Bruce

R. B. Bruce, RLS #1952

✓ 8-E-72 8509

SEP 16 1980

CAROLINA SURVEYING CO.
112 Manly St.
Greenville, S. C.

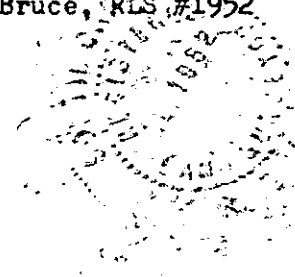

GCTO

1506

3.0001

222/1-1

522 12 1-22